

**E**

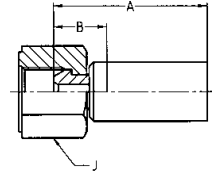

2370N • 2245N • 2380F • 2246F

 Armaturen  
**192NX – 1U0NX**

## 192NX – 60° Dichtkegel mit BSP-Überwurfmutter





**WERKSTOFF** Stahl, verzinkt, transparent Cr(VI)-frei passiviert.  
 Weitere Werkstoffe auf Anfrage.

Artikelnummer #	DN	size	mm	Zoll	Anschlussart Gewindegröße 	A mm	B mm	J mm 	Max. WP MPa 
192NX-4-04	6	-04	6,4	1/4	G 1/4	56	25	19	63,0
192NX-6-05	8	-05	7,9	5/16	G 3/8	52	18	22	55,0
192NX-6-06	10	-06	9,5	3/8	G 3/8	59	19	22	55,0
192NX-8-06	10	-06	9,5	3/8	G 1/2	60	20	27	43,0
192NX-8-08	12	-08	12,7	1/2	G 1/2	63	20	27	43,0
192NX-12-10	16	-10	15,9	5/8	G 3/4	73	22	32	37,5
192NX-12-12	20	-12	19,0	3/4	G 3/4	77	26	32	37,5
192NX-16-12	20	-12	19,0	3/4	G 1	77	26	41	28,0
192NX-16-16	25	-16	25,4	1	G 1	88	27	41	28,0
192NX-20-16	25	-16	25,4	1	G 1 1/4	77	26	50	25,0

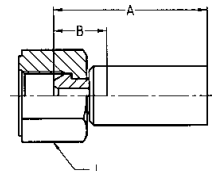
## 1U0NX – Uni-Dichtkopf BSP-Überwurfmutter



**WERKSTOFF** Stahl, verzinkt, transparent Cr(VI)-frei passiviert.  
 Für Armaturen wie oben, jedoch Nippel aus Edelstahl (AISI 303)  
 bitte **C2W** an die Artikelnummer anfügen. Beispiel: 1U0NX-8-08 **C2W**.  
 Weitere Werkstoffe auf Anfrage.

Artikelnummer #	DN	size	mm	Zoll	Anschlussart Gewindegröße 	A mm	B mm	J mm 	Max. WP MPa 
1U0NX-4-04	6	-04	6,4	1/4	G 1/4	58	27	19	63,0
1U0NX-6-04	6	-04	6,4	1/4	G 3/8	58	27	27	55,0
1U0NX-6-05	8	-05	7,9	5/16	G 3/8	59	19	19	55,0
1U0NX-6-06	10	-06	9,5	3/8	G 3/8	61	20	22	55,0
1U0NX-8-06	10	-06	9,5	3/8	G 1/2	61	20	27	43,0
1U0NX-8-08	12	-08	12,7	1/2	G 1/2	61	22	27	43,0
1U0NX-12-10	16	-10	15,9	5/8	G 3/4	75	23	32	37,5
1U0NX-12-12	20	-12	19,0	3/4	G 3/4	78	23	32	37,5
1U0NX-16-12	20	-12	19,0	3/4	G 1	78	23	41	28,0

Armaturen