

FLEXIBLE JAW AND PIN & BUSH COUPLINGS TYPES AND OPERATING DESCRIPTION

Properties of flexible jaw and pin & bush couplings

					
Product	ROTEX®	ROFLEX®	POLY-NORM®	POLY-NORM®-M	REVOLEX®
Type	Torsionally flexible jaw coupling				Torsionally flexible pin & bush coupling
Features					
Torsionally flexible	●	●	●	●	●
Damping vibrations	●	●	●	●	●
Maintenance-free	●	●	●	●	●
Axial plug-in	●	●	●	●	●
Shear type				●	
Fail-safe	●	●	●	●	●
Compensating for misalignment	●	●	●	●	●
Types					
Variant diversity	very high	medium	medium	medium	high
Special features	extensive basic programme available from stock while customised solutions can be realized	basic programme available from stock	basic programme available from stock	Basic programme available from stock, ideal for customised solutions, for applications with high performances	extensive programme, ideal for customised solutions, for applications with high performance ranges
Applications / core industries	manifold applications, applicable in all industries	pump industry, industrial gearboxes	pump industry, industrial gearboxes	heavy mechanical engineering, mills, conveyors, crushers, industrial gearboxes	industrial gearboxes, conveyor systems, industrial fans, cableways, agitators, generators, ...
surface	allover machining, very good dynamic properties	shell surface machined	shell surface machined	shell surface machined	allover machining, good dynamic properties
Torque range T_{KN} [Nm]					
Min.	1	65	40	100,000	4300
Max.	35,000	5,000	67,000	5,500,000	1,350,000
Max. circumferential speed v [m/s]					
Cast EN-GJL (dynamic balancing)	35	35	35		35
Steel + cast EN-GJS (dynamic balancing)	60			35	60
Hub materials available					
Steel (semi-finished product) » customised solutions available	●			●	●
Cast iron (GJL) » subject to mould	●	● ¹⁾	●		●
Nodular iron (GJS) » subject to mould	●		○	●	○
Aluminium wrought products (Al-H) » customised solutions available	●				
Aluminium diecast (Al-D)	●				
Stainless steel	●				
Corrosion-protected types	●		○	●	●
Spiders / elastomers					
Material	T-PUR®, PA, PEEK, Hytrel, ...	T-PUR® (size 68) NBR (from size 80)	NBR (up to size 180) T-PUR® (from size 200)	NBR, NBR electrically insulating	NR, NBR, NBR electrically insulating
Degree of hardness	flexible to torsionally stiff	flexible	flexible	flexible	flexible
Temperature range in °C, min. / max. (standard)	-40 / +120	-30 / +80	-30 / +80	-30 / +80	-30 / +80
Temperature range in °C, min. / max. (special)	-40 / +250	-30 / +80	-30 / +80	-30 / +80	-50 / +80

● ≈ Standard
○ ≈ On request
¹⁾ Size 68 made of sintered steel

FLEXIBLE JAW AND PIN & BUSH COUPLINGS TYPES AND OPERATING DESCRIPTION

Product finder of jaw and pin & bush couplings

					
Product	ROTEX®	ROFLEX®	POLY-NORM®	POLY-NORM®-M	REVOLEX®
Type	Torsionally flexible jaw coupling				Torsionally flexible pin & bush coupling
Geometries					
Design	compact	short	short	short	short
Mass moment of inertia	low	medium	medium	high	medium
Shaft distance dimension	low / average	low	low	low	low
Types (extract)					
Elastomers can be radially disassembled » without displacing driving/driven side	AFN, AH, SH, ZR, DF, DFN, CF-H	SH	ADR, ADR-SB	AFN, A	Standard
Intermediate shaft types » bridging larger shaft distances	ZR, ZWN	–	–	–	customised
Standard spacers 100 mm to 250 mm	ZS-DKM-SH	–	AZR	–	customised
shaft-to-shaft connection	Standard	N	Standard	Standard	Standard
flange-to-shaft connection	CF, CFN	–	–	A	customised
Flange-to-flange connection » particularly short mounting length	DF, DNF	–	–	–	customised
Double-cardanic » compensating for big displacements, lower restoring forces	ZS-DKM-H, ZR, ZWN	–	–	–	–
Certifications / type examinations					
ATEX 	●	●	●	○	●
UL-listed 	●				
DNV/GL 	●			○	●
ABS 	●			○	○
Bureau Veritas 	●			○	○
LR 	●				○
RS CLASS 	○				○
CCS 	○				○
ClassNK 	●				○
Korean Register 	●				○

● ≈ Standard
○ ≈ On request

ROTEX®

Flexible jaw couplings

Types of hubs

Since ROTEX® is used on many different applications and mounting conditions, this coupling system is available with various hub types. These types mainly differ in that they provide either positive or frictionally engaged (backlash-free) connections, but mounting situations like, for example, gear shafts with integrated transmission cams or similar applications are covered, too. Applications are considered.

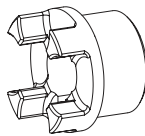

Type 1.0 hub with feather keyway and setscrew

Positive-locking power transmission, permissible torque depending on the permissible surface pressure. Not suitable for backlash-free power transmission with heavily reversing operation.

Type 1.1 hub without feather keyway, with setscrew

Non-positive torque transmission for crimping connections and adhesive bonds. (No ATEX approval)

Type 1.3 hub with spline bore (see page 37)

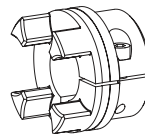

Type 2.3 clamping hub with spline bore

For splines see page 37. Positive-locking power transmission. The friction fit avoids resp. reduces reverse backlash.

Type 2.0 clamping hub single slot without feather keyway

Frictionally engaged, backlash-free shaft-hub-connection. Transmittable torques depending on bore diameter (see page 44). (For ATEX category 3 only)

Type 2.1 clamping hub single slot with feather keyway

Positive-locking power transmission with additional friction fit. The friction fit avoids resp. reduces reverse backlash. Surface pressure of the keyway connection is reduced.

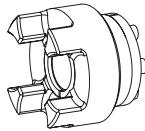

Type 4.2 hub for CLAMPEX® clamping set KTR 250

Frictionally engaged, backlash-free shaft-hub-connection for transmitting average torques.

Type 4.1 for CLAMPEX® clamping set KTR 200
Type 4.3 for CLAMPEX® clamping set KTR 400

Frictionally engaged, backlash-free shaft-hub-connection for the transmission of high torques.

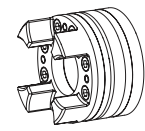

Type 6.0 clamping ring hub (see ROTEX® GS series)

Integrated frictionally engaged shaft-hub-connection for the transmission of higher torques. Screwing on elastomer side. For details about torque and dimensions see page 43. Suitable for high speeds.

Type 6.5 clamping ring hub (see ROTEX® GS series)

Design like 6.0, except for clamping screws externally. For instance for radial disassembly of intermediate pipe (special design).

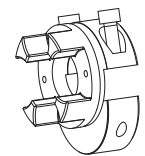

Type 7.6 clamping hub type DH with feather keyway for double-cardanic connection

Positive-locking power transmission with additional friction fit for radial assembly of coupling. The friction fit avoids resp. reduces reverse backlash. Surface pressure of the keyway connection is reduced.

Type 7.5 clamping hub type DH without feather keyway for double-cardanic connection

Frictionally engaged, backlash-free shaft-hub-connection for radial assembly of coupling. Transmittable torques depending on bore diameter. (For ATEX category 3 only)

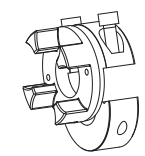

Type 7.9 clamping hub type H with feather keyway

Positive-locking power transmission with additional friction fit for radial assembly of coupling. The friction fit avoids resp. reduces reverse backlash. Surface pressure of the keyway connection is reduced.

Type 7.8 clamping hub type H without feather keyway

Frictionally engaged, backlash-free shaft-hub-connection for radial assembly of coupling. Transmittable torques depending on bore diameter. (For ATEX category 3 only)

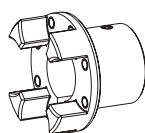

FNN hub

Coupling hub to be connected to an attachment such as brake drum, brake disk and fan.

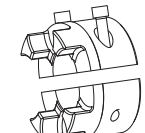

Type 7.1 SPLIT hub with feather keyway

Split hub made of cast iron. Positive-locking power transmission with additional friction fit. The friction fit avoids resp. reduces reverse backlash. Surface pressure of the keyway connection is reduced.

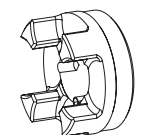

TB1 hub/TB2 hub

Coupling hub for taper clamping sleeves TB1 screwed on cam side. TB2 screwed externally.

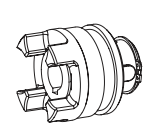

SD hub shifting hub

Coupling hub for separating resp. switching on the driving/driven machine with downtime of the machine. Can be combined with slip ring and shiftable linkage.

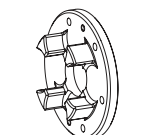

Driving flange type 3b

Driving flange to connect to customer's component. For dimensions see page 48.

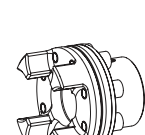

Type 3Na and 4N Driving flange with flange type K

For type AFN and BFN. With type AFN the spider can be replaced when installed without having to disassemble the driving and driven side.

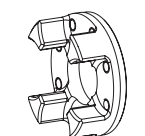

Driving flange type 3Na

Driving flange to connect to customer's component. For dimensions see page 48.

ROTEX®

Flexible jaw couplings

Speeds

ROTEX® size	Maximum speed of hub versions/types													Maximum speed [rpm] depending on outside Ø of brake drum/disk				
	Maximum speed [rpm]													Brake drum (steel)		Brake disk (steel)		
	1.0 / 1.1 / 1.3			2.0 / 2.1 / 2.3 / 7.5 / 7.6 / 7.8 / 7.9	6.0	7.1	TB1 / TB2	FNN 1)	FNN with fan	SD (with shiftable linkage)	3b / 3Na / 4N	DKM / ZS-DKM	ZR	ZRS	Outside Ø [mm]	[rpm]	Outside Ø [mm]	[rpm]
	Steel, GJS, Al-H	GJL, sinter metal	Al-D															
14	10000	10000	3600	-	-	-	-	-	-	-	-	-	-	160	6000	200	8600	
19	10000	10000	3600	10000	-	-	-	-	-	-	-	-	-	200	4800	250	6850	
24	10000	10000	3600	8600	-	10000	10000	-	-	10000	3600	-	-	250	3800	315	5500	
28	10000	10000	3600	7300	-	8800	10000	10000	-	-	3600	-	-	315	3000	355	4850	
38	9500	8300	3600	6000	-	7200	8300	9500	-	3200	9500	3600	-	400	2400	400	4300	
42	8000	7000	3600	5000	-	6000	7000	8000	-	3200	8000	3600	-	500	1900	450	3800	
48	7200	6300	3600	4500	-	5500	6300	7200	-	2500	7200	3600	-	630	1500	500	3500	
55	6300	5500	-	4000	-	4800	5500	6300	-	2100	6300	3600	-	630	1500	560	3050	
65	5600	4900	-	3600	see ROTEX® GS	4200	4900	5600	-	2100	5600	3600	-	710	1350	630	2700	
75	4700	4200	-	3000	-	3600	4200	4700	-	1700	4700	3600	-	710	1350	710	2400	
90	3800	3600	-	2400	-	3000	3600	3800	-	1300	3800	3000	-	800	1200	800	2150	
100	3600	-	-	2100	-	-	2900	3600	-	1300	3600	-	-	-	-	900	1900	
110	3000	-	-	1900	-	-	2600	-	-	1300	3000	-	-	-	-	1000	1700	
125	2600	-	-	1800	-	-	2300	-	-	1200	2600	-	-	-	-	-	-	
140	2400	-	-	1500	-	-	2000	-	-	-	2400	-	-	-	-	-	-	
160	2000	-	-	1300	-	-	-	-	-	-	2000	-	-	-	-	-	-	
180	1800	-	-	1150	-	-	-	-	-	-	1800	-	-	-	-	-	-	
Balancing necessary from a circumferential speed of	v = 30 m/s	v = 30 m/s	On request	v = 20 m/s	-	v = 30 m/s	v = 30 m/s	v = 30 m/s	v = 30 m/s	v = 30 m/s	v = 30 m/s	On request	On request	On request	v = 30 m/s	v = 30 m/s	-	

Depending on the application, balancing may also be required with lower circumferential speeds. Higher speeds possible on request.

1) Please note that the attachments may have a lower permissible maximum speed.

Displacements

Axial displacement ΔK_A

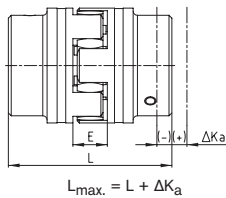

Radial displacement ΔK_r

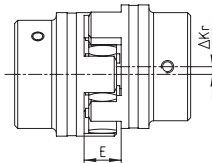

Angular displacement ΔK_W [degree]

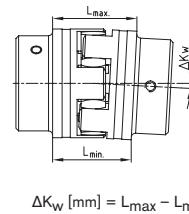

Displacements for spider 92 and 98 Shore A																	
ROTEX® size	14	19	24	28	38	42	48	55	65	75	90	100	110	125	140	160	180
Max. axial displacement ΔK_A [mm]	-0.5 +1.0	-0.5 +1.2	-0.5 +1.4	-0.7 +1.5	-0.7 +1.8	-1.0 +2.0	-1.0 +2.1	-1.0 +2.2	-1.0 +2.6	-1.5 +3.0	-1.5 +3.4	-1.5 +3.8	-2.0 +4.2	-2.0 +4.6	-2.0 +5.0	-2.5 +5.7	-3.0 +6.4
Max. radial displacement with n=1500 rpm ΔK_r [mm]	0.17	0.20	0.22	0.25	0.28	0.32	0.36	0.38	0.42	0.48	0.50	0.52	0.55	0.60	0.62	0.64	0.68
Max. angular displacement with n=1500 rpm ΔK_W [degree]	1.2	1.2	0.9	0.9	1.0	1.0	1.1	1.1	1.2	1.2	1.2	1.2	1.3	1.3	1.2	1.2	1.2
ΔK_W [mm]	0.67	0.82	0.85	1.05	1.35	1.70	2.00	2.30	2.70	3.30	4.30	4.80	5.60	6.50	6.60	7.60	9.00

Displacements for spider 64 Shore D																	
ROTEX® size	14	19	24	28	38	42	48	55	65	75	90	100	110	125	140	160	180
Max. axial displacement ΔK_A [mm]	-0.5 +1.0	-0.5 +1.2	-0.5 +1.4	-0.7 +1.5	-0.7 +1.8	-1.0 +2.0	-1.0 +2.1	-1.0 +2.2	-1.0 +2.6	-1.5 +3.0	-1.5 +3.4	-1.5 +3.8	-2.0 +4.2	-2.0 +4.6	-2.0 +5.0	-2.5 +5.7	-3.0 +6.4
Max. radial displacement with n=1500 rpm ΔK_r [mm]	0.11	0.13	0.15	0.18	0.21	0.23	0.25	0.27	0.30	0.34	0.36	0.37	0.40	0.43	0.45	0.46	0.49
Max. angular displacement with n=1500 rpm ΔK_W [degree]	1.1	1.1	0.8	0.8	0.9	0.9	1.0	1.0	1.1	1.1	1.1	1.1	1.2	1.2	1.1	1.1	1.1
ΔK_W [mm]	0.57	0.76	0.76	0.90	1.25	1.40	1.80	2.00	2.50	3.00	3.80	4.30	5.30	6.00	6.10	7.10	8.00

Displacements for spider PA, PEEK																	
ROTEX® size	14	19	24	28	38	42	48	55	65	75	90	100	110	125	140	160	180
Max. axial displacement ΔK_A [mm]	-0.5 +1.0	-0.5 +1.2	-0.5 +1.4	-0.7 +1.5	-0.7 +1.8	-1.0 +2.0	-1.0 +2.1	-1.0 +2.2	-1.0 +2.6	-1.5 +3.0	-1.5 +3.4	-1.5 +3.8	-2.0 +4.2	-2.0 +4.6	-2.0 +5.0	-2.5 +5.7	-3.0 +6.4
Max. radial displacement with n=1500 rpm ΔK_r [mm]	0.08	0.10	0.11	0.12	0.14	0.16	0.18	0.19	0.21	0.24	0.25	0.26	0.27	0.30	0.31	0.31	0.31
Max. angular displacement with n=1500 rpm ΔK_W [degree]	0.60	0.45	0.45	0.50	0.50	0.55	0.55	0.55	0.60	0.60	0.60	0.60	0.65	0.65	0.65	0.60	0.60
ΔK_W [mm]	0.33	0.41	0.42	0.52	0.67	0.85	1.00	1.15	1.35	1.65	2.15	2.40	2.80	3.25	3.30	3.30	3.30

The specified permissible displacement figures of the flexible ROTEX® couplings are standard values taking into account the load of the coupling up to the rated torque T_{KN} and an operating speed $n = 1500$ rpm along with an ambient temperature of $+30$ °C. The displacement figures may only be used one by one, if they appear simultaneously, they must be limited in proportion. Care should be taken to maintain the distance dimension E accurately in order to allow for axial clearance of the coupling while in operation. Detailed mounting instructions are shown on our homepage www.ktr.com.

ROTEX®
Flexible jaw and pin & bush couplings

ROFLEX®

POLY-NORM®

POLY-NORM®-M

REVOLUX®

ROTEX® Flexible jaw couplings

Selection of standard IEC motors

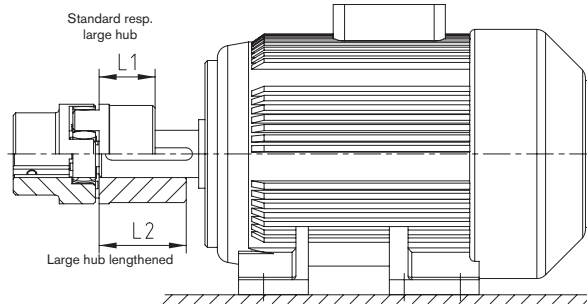
ROTEX® couplings for standard IEC motors, protection class IP 54/IP 55 (spider 98 Shore A)

Size	A. C. motor 50 Hz Shaft end DxL [mm]		Motor 2 poles n= 3000 rpm		ROTEX® coupling size	Motor 4 poles n= 1500 rpm		ROTEX® coupling size	Motor 6 poles n= 1000 rpm		ROTEX® coupling size	Motor 8 poles n= 750 rpm		ROTEX® coupling size
	2 poles	4, 6, 8 poles	Power P [kW]	Torque T _{AN} [Nm]		Power P [kW]	Torque T _{AN} [Nm]		Power P [kW]	Torque T _{AN} [Nm]		Power P [kW]	Torque T _{AN} [Nm]	
63	11 x 23		0.18	0.62	14	0.12	0.88	14	0.06	0.7	14	0.04	0.6	14
			0.25	0.86		0.18	1.3		0.09	1.1		0.09	1.4	
			0.37	1.3		0.25	1.8		0.18	2		0.25	2.8	
71	14 x 30		0.55	1.9	19	0.37	2.5	19	0.25	2.8	19	0.12	1.8	19
			0.75	2.5		0.55	3.7		0.37	3.9		0.18	2.5	
80	19 x 40		1.1	3.7	19	0.75	5.1	19	0.55	5.8	19	0.25	3.5	19
			1.5	5		1.1	7.5		0.75	8		0.37	5.3	
90S	24 x 50		2.2	7.4	24	1.5	10	24	1.1	12	24	0.55	7.9	24
90L	24 x 50		2.2	7.4		2.2	15		2.2	22		1.5	15	
100L	28 x 60		3	9.8	28	3	20	28	1.5	15	28	1.1	16	28
112M	28 x 60		4	13		4	27		4	27		2.2	22	
132S	38 x 80		5.5	18	28	5.5	36	28	3	30	28	2.2	30	28
			7.5	25		7.5	49		4	40		3	40	
132M	38 x 80								5.5	55				
160M	42 x 110		11	36	38	11	72	38	7.5	75	38	4	54	38
			15	49		15	98		11	109		5.5	74	
160L	42 x 110		18.5	60	38	15	98	38	11	109	38	7.5	100	38
180M	48 x 110		22	71		18.5	121		18.5	121		15	148	
180L	48 x 110					22	144		15	148		11	145	
200L	55 x 110		30	97	42	30	196	42	18.5	181	42	15	198	42
			37	120		37	240		22	215		22	215	
225S	55 x 110					37	240					18.5	244	
225M	55 x 110		45	145	48	45	292	48	30	293	48	22	290	48
250M	60 x 140		55	177		55	356		55	37		361	55	
280S	65 x 140		75	241	55	75	484	55	45	438	55	37	483	55
280M	65 x 140		90	289		90	581		90	55		535	90	
315S	65 x 140		110	353	65	110	707	65	75	727	65	55	712	65
315M	65 x 140		132	423		132	849		132	90		873	132	
315L	65 x 140		160	513	75	160	1030	75	110	1070	75	90	1170	75
			200	641		200	1290		132	1280		110	1420	
315	85 x 170								160	1550		132	1710	
			250	802	250	1600	200	1930	250	2070				
355	75 x 140		315	1010	90	315	2020	90	250	2410	90	200	2580	90
			355	1140		355	2280		315	3040		250	3220	
400	80 x 170		400	1280	100	400	2570	100	315	3040	100	250	3220	100
			500	1600		500	3210		400	3850		315	4060	
450	90 x 170		560	1790	110	560	3580	110	450	4330	110	355	4570	110
			630	2020		630	4030		500	4810		400	5150	
450	120 x 210		710	2270	125	710	4540	125	560	5390	125	450	5790	125
			800	2560		800	5120		630	6060		500	6420	
450	120 x 210		900	2880	140	900	5760	140	710	6830	140	560	7190	140
			1000	3200		1000	6400		800	7690		630	8090	

The coupling selection is based on an ambient temperature of up to +40 °C. The selection is based on a minimum safety factor of 2 to the max. coupling torque (T_{K max}). A detailed selection is possible according to catalogue page 14 et seqq. Drives with periodical torque curves must be selected according to DIN 740 part 2. If requested, KTR will perform the selection. Torque T = rated torque according to Siemens-catalogue D81.1 04/2024

 ROTEX®
Flexible jaw and
pin & bush couplings

ROFLEX®

POLY-NORM®

POLY-NORM®-M

REVOLEX®

ROTEX®
 Flexible jaw couplings

Cylindrical bores and inch bores

Bore ØD		Width of keyway B		Keyway depth T2	KTR code Inch bore	ROTEX® basic bores, available from stock Hub material aluminium ●; hub material steel ●; hub material EN-GJL ●											
ØD [mm]	ØD [inch]	B [mm]	B [inch]	T2 [mm]		ROTEX® sizes											
						14	19	24	28	38	42	48	55	65	75	90	
Ø6 H7 +0.012		2 JS9 ±0.0125		7 +0.1		●											
Ø8 H7 +0.015		2 JS9 ±0.0125		9 +0.1		●●	●●										
Ø9 H7 +0.015		3 JS9 ±0.0125		10.4 +0.1		●●	●										
Ø9.525 +0.0254	3/8	3.175 ±0.051	1/8	10.972 ±0.381	Tb												
Ø10 H7 +0.015		3 JS9 ±0.0125		11.4 +0.1		●●	●●	●●									
Ø11 H7 +0.018		4 JS9 ±0.015		12.8 +0.1		●●	●●	●									
Ø11.112 +0.0254	7/16	2.382 ±0.051	3/32	12.293 ±0.381	DNB												
Ø12 H7 +0.018		4 JS9 ±0.015		13.8 +0.1		●●	●●	●●									
Ø12.7 +0.0254	1/2	3.175 ±0.051	1/8	14.224 ±0.381	Ta		●	●									
Ø12.7 +0.0254	1/2	4.762 ±0.051	3/16	14.757 ±0.381	T												
Ø13.495 +0.0254	17/32	3.175 ±0.051	1/8	15.011 ±0.381	DNC												
Ø14 H7 +0.018		5 JS9 ±0.015		16.3 +0.1		●●	●●	●●	●●								
Ø14.287 +0.0254	9/16	3.175 ±0.051	1/8	15.824 ±0.381	Do												
Ø15 H7 +0.018		5 JS9 ±0.015		17.3 +0.1		●●	●●	●●	●								
Ø15.875 +0.0254	5/8	3.175 ±0.051	1/8	17.424 ±0.381	E												
Ø15.875 +0.0254	5/8	3.968 ±0.051	5/32	17.729 ±0.381	Es		●	●	●								
Ø15.875 +0.0254	5/8	4.762 ±0.051	3/16	18.008 ±0.381	Ed		●	●	●								
Ø16 H7 +0.018		5 JS9 ±0.015		18.3 +0.1		●●	●●	●●	●●								
Ø17 H7 +0.018		5 JS9 ±0.015		19.3 +0.1			●●	●●	●								
Ø17.462 +0.0254	11/16	4.762 ±0.051	3/16	19.634 ±0.381	DNH												
Ø18 H7 +0.018		6 JS9 ±0.015		20.8 +0.1		●●	●●	●●	●								
Ø19 H7 +0.021		6 JS9 ±0.015		21.8 +0.1		●●	●●	●●	●								
Ø19.05 +0.0254	3/4	3.175 ±0.051	1/8	20.624 ±0.381	Ad												
Ø19.05 +0.0254	3/4	4.762 ±0.051	3/16	21.259 ±0.381	A		●	●	●	●							
Ø20 H7 +0.021		6 JS9 ±0.015		22.8 +0.1		●●	●●	●●	●●	●	●						
Ø22 H7 +0.021		6 JS9 ±0.015		24.8 +0.1		●	●●	●●	●	●	●						
Ø22.225 +0.0254	7/8	4.762 ±0.051	3/16	24.485 ±0.381	G		●	●	●	●	●						
Ø22.225 +0.0254	7/8	6.35 ±0.051	1/4	25.069 ±0.381	F		●	●	●	●	●						
Ø23.812 +0.0254	15/16	6.35 ±0.051	1/4	26.695 ±0.381	Gf												
Ø24 H7 +0.021		8 JS9 ±0.018		27.3 +0.2		●●	●●	●●	●●	●	●						
Ø25 H7 +0.021		8 JS9 ±0.018		28.3 +0.2		●	●●	●●	●●	●●	●	●	●				
Ø25.4 +0.0254	1	4.762 ±0.051	3/16	27.686 ±0.381	H												
Ø25.4 +0.0254	1	6.35 ±0.051	1/4	28.295 ±0.381	Hs		●	●	●	●	●						
Ø26.987 +0.0254	1 1/16	4.762 ±0.051	3/16	29.286 ±0.381	R												
Ø28 H7 +0.021		8 JS9 ±0.018		31.3 +0.2		●●	●●	●●	●●	●	●						
Ø28.575 +0.0254	1 1/8	6.35 ±0.051	1/4	31.521 ±0.381	Sb		●	●	●	●	●						
Ø28.575 +0.0254	1 1/8	7.937 ±0.051	5/16	32.105 ±0.381	Sd		●	●	●	●	●						
Ø30 H7 +0.021		8 JS9 ±0.018		33.3 +0.2		●	●●	●●	●●	●●	●	●	●				
Ø31.75 +0.0254	1 1/4	6.35 ±0.051	1/4	34.721 ±0.381	Js												
Ø31.75 +0.0254	1 1/4	7.937 ±0.051	5/16	35.331 ±0.381	K		●	●	●	●	●	●	●	●			
Ø32 H7 +0.025		10 JS9 ±0.018		35.3 +0.2		●●	●●	●●	●●	●●	●	●	●	●			
Ø34.925 +0.0254	1 3/8	7.937 ±0.051	5/16	38.557 ±0.381	Ma		●	●	●	●	●						
Ø34.925 +0.0254	1 3/8	9.525 ±0.0635	3/8	39.141 ±0.381	RH1												
Ø35 H7 +0.025		10 JS9 ±0.018		38.3 +0.2		●●	●●	●●	●●	●●	●	●	●	●			
Ø36.512 +0.0254	1 7/16	9.525 ±0.0635	3/8	40.767 ±0.381	Cb												
Ø38 H7 +0.025		10 JS9 ±0.018		41.3 +0.2		●●	●●	●●	●●	●●	●	●	●	●			
Ø38.1 +0.0254	1 1/2	7.937 ±0.051	5/16	41.783 ±0.381	Ca												
Ø38.1 +0.0254	1 1/2	9.525 ±0.0635	3/8	42.392 ±0.381	C												
Ø40 H7 +0.025		12 JS9 ±0.0215		43.3 +0.2			●	●	●	●	●	●	●	●	●		
Ø41.275 +0.0254	1 5/8	9.525 ±0.0635	3/8	45.618 ±0.381	Nb												
Ø42 H7 +0.025		12 JS9 ±0.0215		45.3 +0.2			●	●	●	●	●	●	●	●	●		
Ø44.45 +0.0254	1 3/4	9.525 ±0.0635	3/8	48.818 ±0.381	Ls												
Ø44.45 +0.0254	1 3/4	11.112 ±0.0635	7/16	49.428 ±0.381	L												
Ø45 H7 +0.025		14 JS9 ±0.0215		48.8 +0.2			●	●	●	●	●	●	●	●	●		
Ø47.625 +0.0254	1 7/8	12.7 ±0.0635	1/2	53.238 ±0.381	Lu												
Ø48 H7 +0.025		14 JS9 ±0.0215		51.8 +0.2			●	●	●	●	●	●	●	●	●		
Ø49.212 +0.0254	1 15/16	12.7 ±0.0635	1/2	54.864 ±0.381	Da												
Ø50 H7 +0.025		14 JS9 ±0.0215		53.8 +0.2			●	●	●	●	●	●	●	●	●		
Ø50.8 +0.0254	2	12.7 ±0.0635	1/2	56.464 ±0.381	Ds												
Ø53.975 +0.0381	2 1/8	12.7 ±0.0635	1/2	59.69 ±0.381	Pa												
Ø55 H7 +0.03		16 JS9 ±0.0215		59.3 +0.2			●	●	●	●	●	●	●	●	●		
Ø57.15 +0.0381	2 1/4	12.7 ±0.0635	1/2	62.915 ±0.381	U												
Ø60 H7 +0.03		18 JS9 ±0.0215		64.4 +0.2			●	●	●	●	●	●	●	●	●		
Ø60.325 +0.0381	2 3/8	15.875 ±0.076	5/8	67.335 ±0.381	Ub												
Ø65 H7 +0.03		18 JS9 ±0.0215		69.4 +0.2			●	●	●	●	●	●	●	●	●		
Ø70 H7 +0.03		20 JS9 ±0.028		74.9 +0.2													
Ø75 H7 +0.03		20 JS9 ±0.028		79.9 +0.2													
Ø80 H7 +0.03		22 JS9 ±0.028		85.4 +0.2													
Ø85 H7 +0.035		22 JS9 ±0.028		90.4 +0.2													
Ø85.725 +0.0381	3 3/8	22.225 ±0.076	7/8	95.504 ±0.381	Wd												
Ø90 H7 +0.035		25 JS9 ±0.028		95.4 +0.2													
Ø92.075 +0.0381	3 5/8	22.225 ±0.076	7/8	101.955 ±0.381	Wf												
Ø100 H7 +0.035		28 JS9 ±0.028		106.4 +0.2													

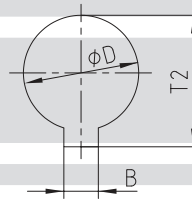

For manufacturing reasons KTR reserves the right to insert a recess on the cam side.

ROTEX®

Flexible jaw couplings

 ROTEX®
Flexible jaw and pin & bush couplings

Spline bores

Basic range ANSI B92.1-involute spline											
Spline code	Size	Pitch circle	pitch	No. of teeth	Angle	Spline code	Size	Pitch circle	pitch	No. of teeth	Angle
PH-S	5/8"	14.28	16/32	9	30°	PS-S	1 1/2"	35.98	12/24	17	30°
PI-S	3/4"	17.46	16/32	11	30°	PD-S	1 1/2"	36.51	16/32	23	30°
PB-S	7/8"	20.63	16/32	13	30°	PE-S	1 3/4"	42.86	16/32	27	30°
PB-BS	1"	23.81	16/32	15	30°	PK-S	1 3/4"	41.275	8/16	13	30°
PJ	1 1/8"	26.98	16/32	17	30°	PT-C ¹⁾	2"	47.625	8/16	15	30°
PC-S	1 1/4"	29.63	12/24	14	30°	PQ-C ¹⁾	2 1/4"	53.975	8/16	17	30°
PA-S	1 3/8"	33.33	16/32	21	30°						

Basic programme of spline bores acc. to DIN 5482									
Size	Pitch circle	Module	No. of teeth	Profile correction	Size	Pitch circle	Module	No. of teeth	Profile correction
A 17 x 14	14.40	1.6	9	+0.600 ²⁾	A 35 x 31	31.50	1.75	18	+0.676
A 20 x 17	19.20	1.6	12	-0.200	A 40 x 36	38.00	1.9	20	+0.049
A 25 x 22	22.40	1.6	14	+0.550	A 45 x 41	44.00	2	22	+0.181
A 28 x 25	26.25	1.75	15	+0.302	A 50 x 45	48.00	2	24	+0.181
A 30 x 27	28.00	1.75	16	+0.327					

Basic programme of spline bores acc. to DIN 5480							
Spline code	Pitch circle	Module	No. of teeth	Spline code	Pitch circle	Module	No. of teeth
20 x 1 x 18 x 8H	18.0	1	18	40 x 2 x 18 x 8H	36.0	2	18
20 x 1.25 x 14 x 8H	17.5	1.25	14	45 x 2 x 21 x 8H	41.0	2	21
25 x 1.25 x 18 x 8H	22.5	1.25	18	48 x 2 x 22 x 9H	44.0	2	22
28 x 1.25 x 21 x 8H	26.25	1.25	21	50 x 2 x 24 x 8H	48.0	2	24
30 x 2 x 14 x 8H	26.0	2	14	60 x 2 x 28 x 8H	56.0	2	28
32 x 2 x 14 x 8H	28.0	2	14	75 x 3 x 24 x 8H	72.0	3	24
35 x 2 x 16 x 8H	32.0	2	16	80 x 3 x 25 x 8H	75.0	3	25

Basic programme of spline bores acc. to DIN 9611 - ISO 500 (p.t.o. shaft connection)				
Size	Width of keyway	No. of teeth	Tip circle	Root circle
1 3/8"	8.69	6	34.93	29.65
1 3/8"	-	21	34.95	34.80 ³⁾
1 3/4"	11.07	6	44.45	37.74
1 3/4"	-	20	45.20	40.20

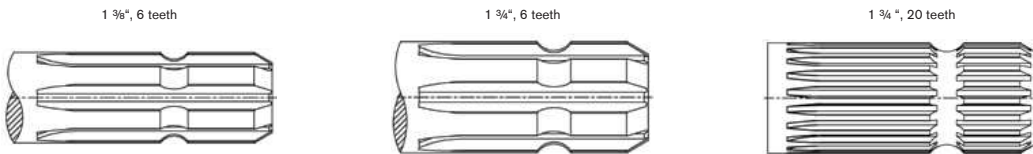

Spline clamping hubs are often adapted to the shafts of hydraulic pump/hydraulic motor shafts. Please contact us for the respective hub length of the spline code!

¹⁾ For clamping hubs only, with plug-in hubs use code PT or PQ.

²⁾ Profile correction different from DIN

³⁾ Similar to code PA-S

Taper bores

Basic programme taper 1:8					
Code	D ^{+0.05}	(D2)	B ^{ISO}	T2 ^{+0.1}	LK
N/1	9.7	7.575	2.4 ^{+0.05}	10.85	17.0
N/1c	11.6	9.5375	3 ^{ISO}	12.90	16.5
N/1e	13.0	10.375	2.4 ^{+0.05}	13.80	21.0
N/1d	14.0	11.813	3 ^{ISO}	15.50	17.5
N/1b	14.3	11.8625	3.2 ^{+0.05}	15.65	19.5
N/2	17.287	14.287	3.2 ^{+0.05}	18.24	24.0
N/2a	17.287	14.287	4 ^{ISO}	18.94	24.0
N/2b	17.287	14.287	3 ^{ISO}	18.34	24.0
N/3	22.002	18.502	4 ^{ISO}	23.40	28.0
N/4	25.463	20.963	4.78 ^{+0.05}	27.83	36.0
N/4b	25.463	20.963	5 ^{ISO}	28.23	36.0
N/4a	27.0	22.9375	4.78 ^{+0.05}	28.80	32.5
N/4g	28.45	23.6375	6 ^{ISO}	29.32	38.5
N/5	33.176	27.676	6.38 ^{+0.05}	35.39	44.0
N/5a	33.176	27.676	7 ^{ISO}	35.39	44.0

With code N/6 and N/6a keyway in parallel with taper.

Basic programme of taper 1:10					
Code	D ^{+0.05}	(D2)	B ^{ISO}	T2 ^{+0.1}	LK
CX	19.95	16.75	5 ^{ISO}	22.08	32
DX	24.95	20.45	6 ^{ISO}	26.68	45
EX	29.75	24.75	8 ^{ISO}	31.88	50

Basic programme taper 1:5					
Code	D ^{+0.05}	(D2)	B ^{ISO}	T2 ^{+0.1}	LK
A-10	9.85	7.55	2 ^{ISO}	1.0	11.5
B-17	16.85	13.15	3 ^{ISO}	1.8	18.5
C-20	19.85	15.55	4 ^{ISO}	2.2	21.5
Cs-22	21.95	17.65	3 ^{ISO}	1.8	21.5
D-25	24.85	19.55	5 ^{ISO}	2.9	26.5
E-30	29.85	23.55	6 ^{ISO}	2.6	31.5
F-35	34.85	27.55	6 ^{ISO}	2.6	36.5
G-40	39.85	32.85	6 ^{ISO}	2.6	35.0

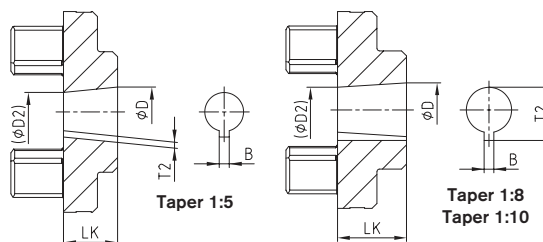

POLY-NORM®-M

REVOLUX®

ROTEX® Standard Flexible jaw couplings

Materials: aluminium + cast + sinter material

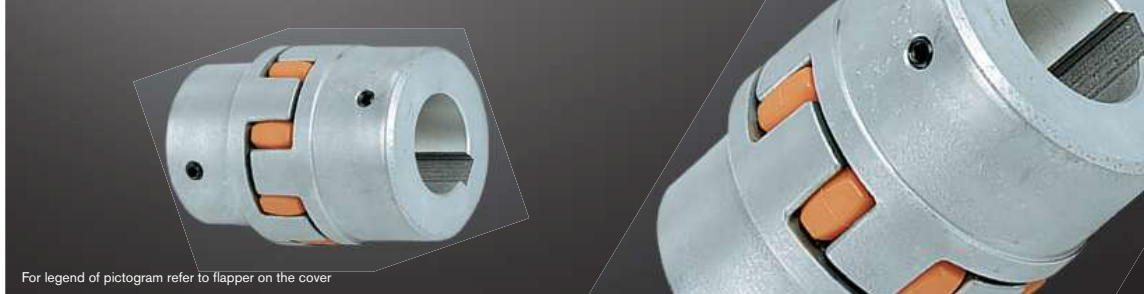

For legend of pictogram refer to flapper on the cover

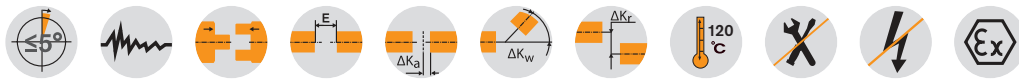

ROTEX® Sintered steel (Sint)																		
Size	Component	Spider ¹⁾ (component 2) Rated torque [Nm]			Finish bore D (min. - max.)	Dimensions [mm]										Setscrew		
		92 ShA	98 ShA	64 ShD		General										G	T	TA [Nm]
14	1a	7.5	12.5	—	0-16	DH	L	L1, L2	E	S	B1	DI1	DN	N				
19	1a	10	17	—	0-25	30	35	11	13	1.5	10	10	30	—	M 4	5	1.5	
24	1a	35	60	—	0-35	40	66	25	16	2.0	12	18	40	—	M 5	10	2	
						56	78	30	18	2.0	14	27	56	—	M 5	10	2	

ROTEX® Aluminium diecast (Al-D) 																	
19	1	10	17	—	0-19	41	66	25	16	2	12	18	32	20	M 5	10	2
	1a				19-24								41				
24	1	35	60	—	0-24	56	78	30	18	2	14	27	40	24	M 5	10	2
	1a				22-28								56				
28	1	95	160	—	0-24	66	90	35	20	2.5	15	30	48	28	M 8	15	10
	1a				24-38								66				
38	1	190	325	—	0-38	114	45	24	18	3.0	80	38	66	36	M 8	15	10
	1a				25-45								77				

ROTEX® Aluminium (Al-H)																	
14	1a	7.5	12.5	16	0-16	30	35	11	13	1.5	10	10.5	-	-	M 4	5	1.5
19	1a	10	17	26	0-24	40	66	25	16	2.0	12	18	-	-	M 5	10	2
24	1a	35	60	75	0-28	55	78	30	18	2.0	14	27	-	-	M 5	10	2
28	1a	95	160	200	0-38	65	90	35	20	2.5	15	30	-	-	M 8	15	10
38	1a	190	325	405	0-45	80	114	45	24	3.0	18	38	-	-	M 8	15	10
42	1a	265	450	560	0-55	95	126	50	26	3.0	20	46	-	-	M 8	20	10
48	1a	310	525	655	0-62	105	140	56	28	3.5	21	51	-	-	M 8	20	10

The coupling is provided with a ROTEX® GS spider as a standard (ROTEX® standard spider available, if requested).

ROTEX® Cast iron (GJL)																	
38	1	190	325	405	12-40	80	114	45	24	3	18	38	66	37	M 8	15	10
	1a				38-48								78	62			
	1b				12-48		164	70									
42	1	265	450	560	14-45	95	126	50	26	3	20	46	75	40	M 8	20	10
	1a				42-55								94	65			
	1b				14-55		176	75									
48	1	310	525	655	15-52	105	140	56	28	3.5	21	51	85	45	M 8	20	10
	1a				48-62								104	69			
	1b				15-62		188	80									
55	1	410	685	825	20-60	120	160	65	30	4	22	60	98	52	M 10	20	17
	1a				55-74								118				
65	1	625	940	1175	22-70	135	185	75	35	4.5	26	68	115	61	M 10	20	17
75	1	1280	1920	2400	30-80	160	210	85	40	5	30	80	135	69	M 10	25	17
90	1	2400	3600	4500	40-100	200	245	100	45	5.5	34	100	160	81	M 12	30	40

ROTEX® Nodular iron (GJS)																	
100	1	3300	4950	6185	50-115	225	270	110	50	6	38	113	180	89	M 12	30	40
110	1	4800	7200	9000	60-125	255	295	120	55	6.5	42	127	200	96	M 16	35	80
125	1	6650	10000	12500	60-145	290	340	140	60	7	46	147	230	112	M 16	40	80
140	1	8550	12800	16000	60-160	320	375	155	65	7.5	50	165	255	124	M 20	45	140
160	1	12800	19200	24000	80-185	370	425	175	75	9	57	190	290	140	M 20	50	140
180	1	18650	28000	35000	85-200	420	475	195	85	10.5	64	220	325	156	M 20	50	140

■ = Unless any material is specified in the order, it is defined with the calculation/order.

¹⁾ Maximum torque of the coupling $T_{K \max} = \text{rated torque of the coupling } T_{KN} \times 2$. For selection see page 14 et seqq.

Ordering example:	ROTEX® 38	GJL	92 ShA	1a	Ø45	1	Ø25
	Coupling size	Material	Spider hardness	Component	Finish bore	Component	Finish bore

ROTEX®

 Flexible jaw and
pin & bush couplings

ROFLEX®

POLY-NORM®

POLY-NORM®-M

REVOLEX®

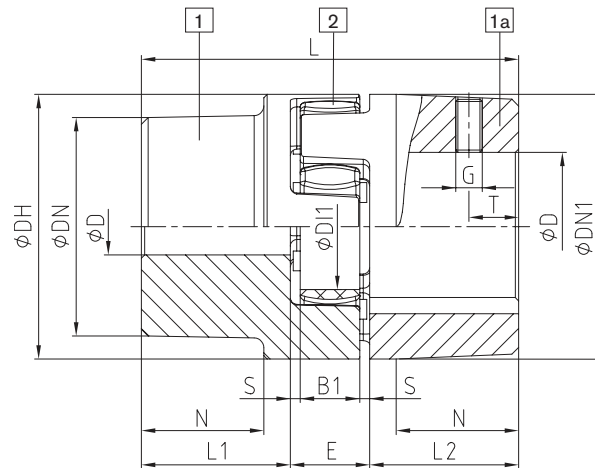
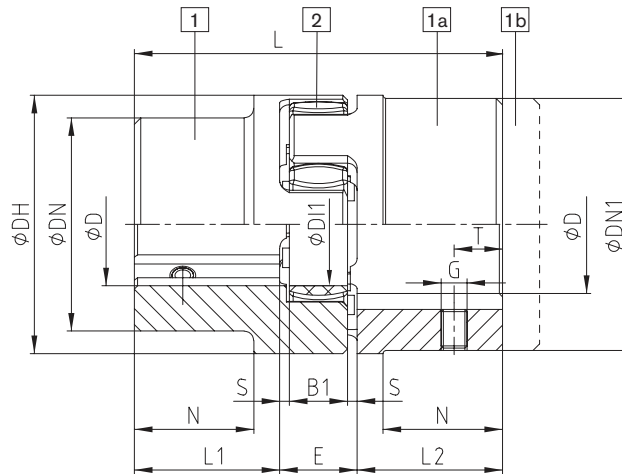
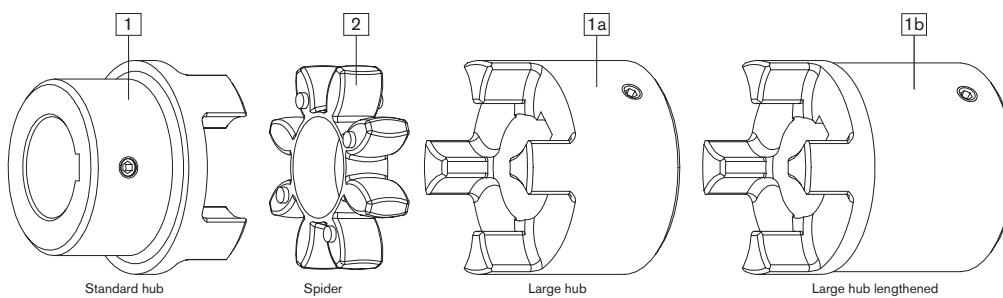
Components

AI-D (thread opposite the keyway)

GJL / GJS (thread on the keyway)

ROTEX® Flexible jaw couplings

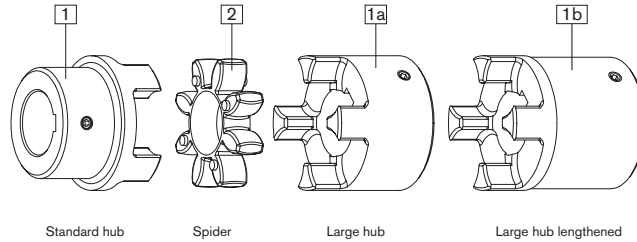
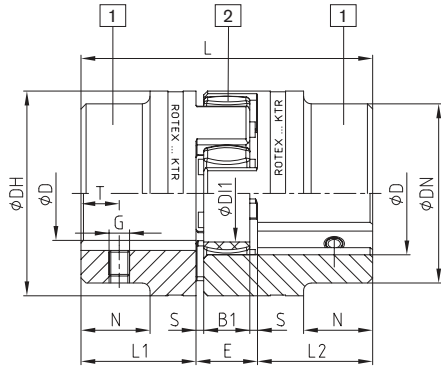
DIN EN 10204 - 3.1 and 3.2 material test certificate

Components



Steel (thread on the keyway)

ROTEX® Coupling hubs with test certificate ¹⁾				
Size	Component	Material ²⁾	Inspection certificate acc. to DIN EN 10204	Notch impact strength
19	1a	S355 ²⁾	3.1	>=27 J
24	1a	S355 ²⁾	3.1	>=27 J
28	1a	S355 ²⁾	3.1	>=27 J
38	1a	S355 ²⁾	3.1	>=27 J
42	1	S355 ²⁾	3.1	>=27 J
48	1	S355 ²⁾	3.1	>=27 J
55	1	S355 ²⁾	3.1	>=27 J
65	1	S355 ²⁾	3.1	>=27 J
75	1	S355 ²⁾	3.1/3.2	>=27 J
		42CrMoS4+QT ³⁾		
90	1	S355 ²⁾	3.1/3.2	>=27 J
		42CrMoS4+QT ³⁾		
100	1	S355 ²⁾	3.1/3.2	>=27 J
		42CrMoS4+QT ³⁾		
110	1	S355 ²⁾	3.1/3.2	>=27 J
		42CrMoS4+QT ³⁾		
120	1	S355 ²⁾	3.1/3.2	>=27 J
		42CrMoS4+QT ³⁾		
140	1	S355 ²⁾	3.1/3.2	>=27 J
		42CrMoS4+QT ³⁾		
160	1	S355 ²⁾	3.1/3.2	>=27 J
		42CrMoS4+QT ³⁾		
180	1	S355 ²⁾	3.1/3.2	>=27 J
		42CrMoS4+QT ³⁾		

¹⁾ S355 suitable for feather key connections, 42CrMoS4+QT for oil press-fits

²⁾ Notch impact strength with -40 °C

³⁾ Notch impact strength with -20 °C

Marine programme:

Hub materials S355J2+N and 42CrMo4+QT acc. to DIN EN 10204 - 3.1+3.2, size 75 - 180 available from stock.



UL



Use in fire pumps

ROTEX® couplings comply with the specifications of NFPA 20 standards for the installation of stationary pumps for fire protection and due to completion of the endurance tests required they also comply with the specifications of UL 448A, flexible couplings and connection shafts for stationary fire pumps.

Sizes available:



ROTEX® UL Listed								
Size	Component	Material	Spider (component 2) Rated torque [Nm]	Dimensions [mm]				
				Finish bore D (min. - max.)	DH	L	L1; L2	E
42	1	St	265	18-55	95	126	50	26
55	1	St	410	24-74	120	160	65	30
65	1	St	625	24-80	135	185	75	35
75	1	St	1280	24-95	160	210	85	40
90	1	St	2400	30-110	200	245	100	45

* for complete dimensions see table on page 40

ROTEX®
Flexible jaw and pin & bush couplings

ROFLEX®

POLY-NORM®

POLY-NORM®-M

REVOLUX®

ROTEX®
 Flexible jaw couplings

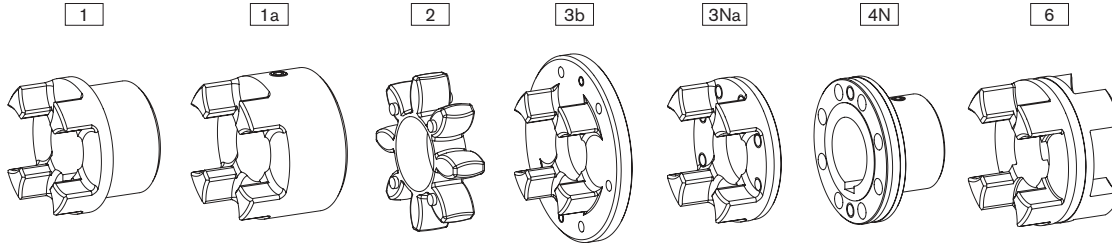
Weights and mass moments of inertia

ROTEX® individual components														
Size	Standard hub				Large hub			Spider	Driving flange				Coupling flange	DKM spacer
	Component 1				Component 1a			Component 2	Component 3b	Component 3Na		Component 4N	Component 6	
	Aluminium [kg] [kgm²]	GJL [kg] [kgm²]	GJS [kg] [kgm²]	St [kg] [kgm²]	Aluminium [kg] [kgm²]	GJL [kg] [kgm²]	St [kg] [kgm²]	Polyurethane (Vulkollan) [kg] [kgm²]	GJS [kg] [kgm²]	St [kg] [kgm²]	GJS [kg] [kgm²]	St [kg] [kgm²]	Aluminium [kg] [kgm²]	
14	—	—	—	—	0.020	—	—	0.0044	—	—	—	—	—	
—	—	—	—	—	0.000003	—	—	0.0000005	—	—	—	—	—	
19	0.064	—	—	—	0.074	—	0.25	0.0057	—	—	—	—	—	
—	0.00001	—	—	—	0.00002	—	0.00006	0.000001	—	—	—	—	—	
24	0.123	—	—	—	0.174	—	0.55	0.014	0.028	0.145	—	0.30	0.14	
—	0.00004	—	—	—	0.00008	—	0.00023	0.000006	0.00023	0.00007	—	0.00009	0.00006	
28	0.200	—	—	—	0.264	—	0.89	0.024	0.54	0.232	—	0.49	0.22	
—	0.00010	—	—	—	0.00019	—	0.00053	0.00001	0.00007	0.00017	—	0.0002	0.00013	
38	0.44	1.16	—	1.6	0.470	1.32	1.74	0.042	0.73	—	0.313	0.87	0.35	
—	0.00033	0.00086	—	0.00151	0.00046	0.00135	0.00155	0.00004	0.001	—	0.00038	0.0005	0.00035	
42	0.69	1.75	—	2.44	0.772	2.05	2.74	0.065	1.26	—	0.608	1.4	0.47	
—	0.00067	0.00178	—	0.00281	0.00111	0.00291	0.00343	0.00008	0.0032	—	0.00089	0.0011	0.00068	
48	0.80	2.44	—	3.34	1.01	2.78	3.72	0.086	1.45	—	0.755	1.92	0.62	
—	0.0012	0.00308	—	0.00473	0.00174	0.00484	0.00570	0.00013	0.0043	—	0.001358	0.0018	0.0011	
55	—	3.68	—	5.05	—	4.08	5.57	0.11	2.58	—	1.243	2.93	0.90	
—	—	0.00615	—	0.00948	—	0.00926	0.01193	0.00023	0.0105	—	0.002920	0.0037	0.0021	
65	—	5.67	—	6.79	—	6.04	8.22	0.17	3.10	—	1.635	4.36	1.31	
—	—	0.01240	—	0.01516	—	0.01789	0.02079	0.00043	0.0149	—	0.004891	0.0069	0.0039	
75	—	8.72	—	10.5	—	9.53	14.3	0.32	4.46	—	2.511	6.80	1.97	
—	—	0.02644	—	0.03269	—	0.03946	0.05069	0.001166	0.0281	—	0.01050	0.0151	0.0082	
90	—	14.8	—	18.7	—	18.2	24.0	0.57	6.94	—	4.151	12.84	3.45	
—	—	0.06730	—	0.08742	—	0.15086	0.13151	0.00326	0.0651	—	0.02723	0.0448	0.0224	
100	—	—	19.7	—	—	—	—	0.82	10.2	—	6.350	16.16	—	
—	—	—	0.11694	—	—	—	—	0.00592	0.1165	—	0.05273	0.0798	—	
110	—	—	27.4	—	—	—	—	1.14	—	—	8.578	21.35	—	
—	—	—	0.20465	—	—	—	—	0.01048	—	—	0.09121	0.2824	—	
125	—	—	42.3	—	—	—	—	1.56	—	—	12.598	34.33	—	
—	—	—	0.40727	—	—	—	—	0.01878	—	—	0.17469	0.3229	—	
140	—	—	58.1	—	—	—	—	2.02	—	—	17.271	48.69	—	
—	—	—	0.67739	—	—	—	—	0.02989	—	—	0.29247	0.4917	—	
160	—	—	84.2	—	—	—	—	3.08	—	—	26.305	71.08	—	
—	—	—	1.31729	—	—	—	—	0.06049	—	—	0.59436	0.9693	—	
180	—	—	118.5	—	—	—	—	5.04	—	—	33.076	109.43	—	
—	—	—	2.30835	—	—	—	—	0.13295	—	—	0.97394	1.9650	—	

Weight and mass moment of inertia each refer to the average finish bore without feather keyway.

 For continuously updated data refer to our online catalogue at www.ktr.com

Archivierung: 11/2025

 ROTEX®
 Flexible jaw and pin & bush couplings

ROFLEX®

POLY-NORM®

POLY-NORM®-M

REVOLEX®

ROTEX®
 Flexible jaw couplings

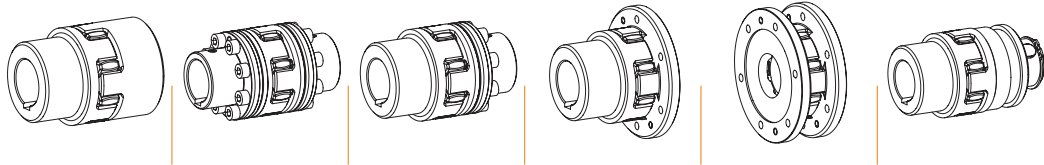
Weights and mass moments of inertia

ROTEX® Complete coupling types												
Size	Standard		AFN		BFN		CF		DF		SD	
	Weight [kg]	Mass moment of inertia J [kgm²]	Weight [kg]	Mass moment of inertia J [kgm²]	Weight [kg]	Mass moment of inertia J [kgm²]	Weight [kg]	Mass moment of inertia J [kgm²]	Weight [kg]	Mass moment of inertia J [kgm²]	Weight [kg]	Mass moment of inertia J [kgm²]
19	0.51	0.000121	—	—	—	—	0.44	0.00016	0.38	0.00020	0.42	0.00008
24	1.1	0.000466	0.98	0.00036	1.1	0.00041	0.84	0.00047	0.57	0.00047	1.1	0.00046
28	1.8	0.00107	1.6	0.00083	1.7	0.00095	1.5	0.00124	1.1	0.00141	1.9	0.00106
38	2.5	0.00171	2.8	0.00209	2.6	0.00193	1.9	0.00217	1.5	0.00259	3.0	0.00435
42	3.9	0.00476	4.5	0.00472	4.1	0.00419	3.1	0.00513	2.6	0.00662	4.4	0.00804
48	5.3	0.00805	5.9	0.00736	5.5	0.00684	3.9	0.00755	3.0	0.00881	6.2	0.00223
55	7.9	0.01564	8.9	0.01480	8.3	0.01369	6.4	0.01692	5.3	0.02131	9.8	0.0166
65	11.9	0.03071	12.9	0.0266	12.3	0.0259	8.9	0.02780	6.4	0.003037	14.9	0.0326
75	18.6	0.06706	20.6	0.0601	19.3	0.0572	13.5	0.0557	9.2	0.05741	23.2	0.0706
90	33.6	0.22139	37.8	0.1718	34.2	0.1551	22.3	0.1356	14.5	0.1333	40.5	0.1891
100	40.2	0.23976	49.6	0.3068	45.2	0.2737	30.9	0.2401	21.2	0.2394	46.7	0.2467
110	56.0	0.42027	67.5	0.5385	61.7	0.4793	42.9	0.4324	29.8	0.4446	61.5	0.4186
125	86.2	0.83426	102.6	1.0485	94.4	0.9413	64.4	0.8187	42.2	0.8031	96.8	0.8497
140	118.3	1.38607	141.2	1.743	129.7	1.564	90.4	1.4221	62.5	1.4580	127.8	1.368
160	171.6	2.69781	210.3	3.517	190.9	3.107	127.6	2.589	83.6	2.4805	190.3	2.723
180	242.25	4.75449	306.6	6.582	274.4	5.668	175.1	4.448	107.9	4.141	262.2	4.810

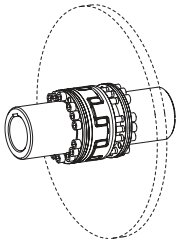

AFN-SB spec. without brake disk		
Size	Weight [kg]	Mass moment of inertia J [kgm²]
65	13.7	0.03126
75	21	0.06828
90	39	0.20132
100	53	0.34637
110	74	0.61684
125	101	1.12844
140	145	1.95075
160	200	3.67846
180	262	6.41621